

Stock Abbreviation: STEP
Stock Code: 002527

STEP ADTECH

STEP/ADTECH Cobot

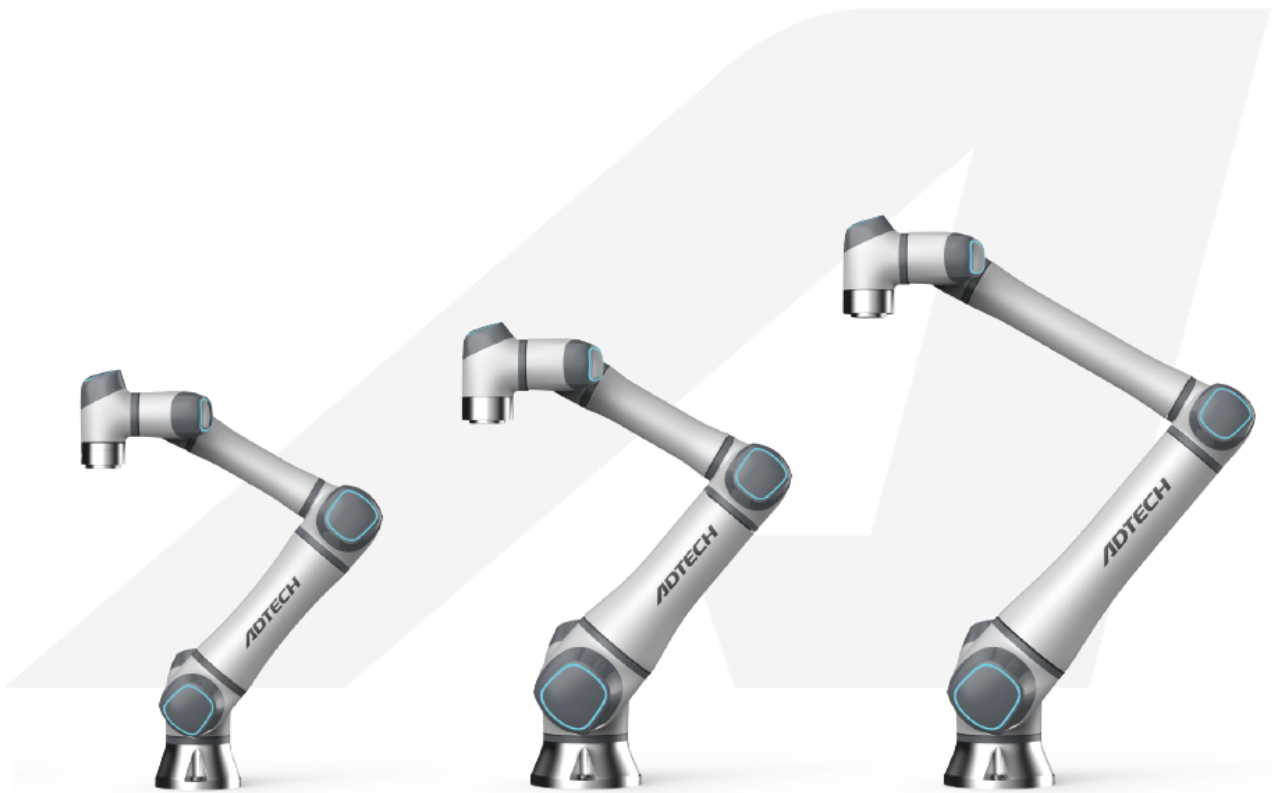

Control System



- **More Secure**
 - Built-in safety module with PL d-level design
 - Built-in collision detection ensures a secure human-robot workspace
- **Integrated Design**
 - Vision controller combines vision, motion, and control—saving about 20% of cabinet space
 - Supports both DC 48 V and AC 220 V inputs (optional)
- **Scalable Architecture**
 - EtherCAT-based servo control allows easy integration with multi-brand joint modules
 - Supports various six-axis cobot configurations

Control cabinet specifications	Model	CRC820-B-A00
	IP rating	IP54
	I/O Ports	24 digital inputs/24 digital outputs, 2 analog inputs/2 analog outputs
	Dimensions (mm)	320*350*135
	Weight (kg)	IP54 version: approx. 10 kg (excluding 1.9 kg power supply)
	Operating Temperature (°C)	0~50
	Power supply	DC48V, 2KW (optional AC 220 V)

Application Scenarios

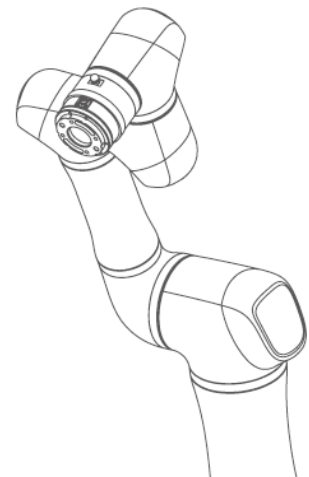

VER3.0

Collaborative Robots | Business Hotline

400-168-2718

400-920-0275



众为兴微信服务号
WECHAT ACCOUNT (ADITECH)



机器人微信服务号
WECHAT ACCOUNT (ROBOT)



微信服务号
WECHAT ACCOUNT



新时达官网
OFFICIAL WEBSITE

Product specifications are for reference only and may change without prior notice. Please consult your sales representative to confirm details before placing an order.

202509 CN

SCR 16 Unit: mm

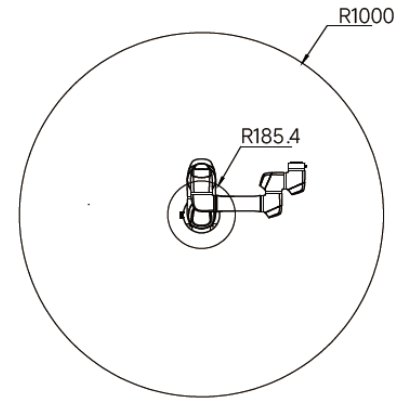
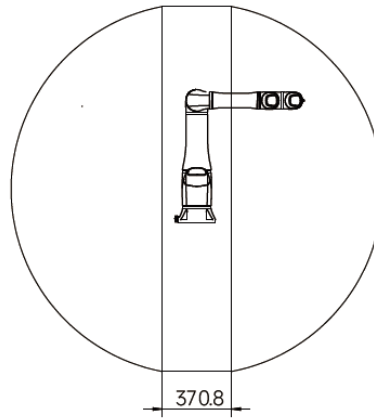
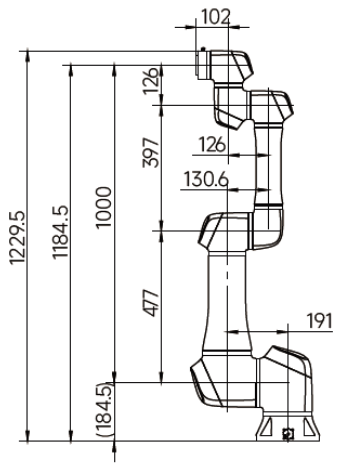

SCR 20 Unit: mm

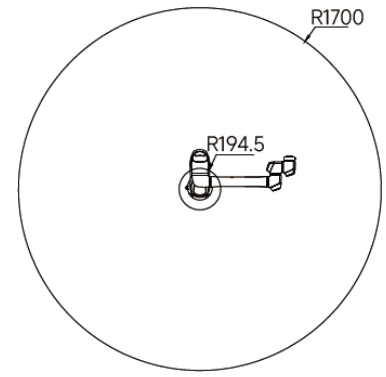
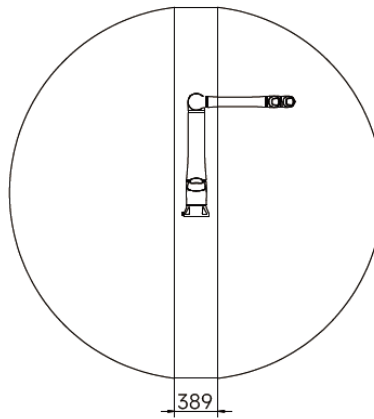
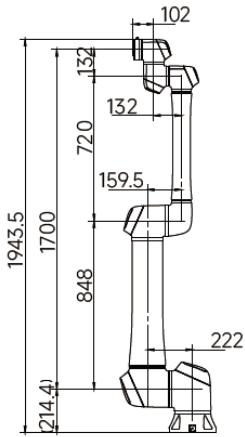

SCR 30 Unit: mm

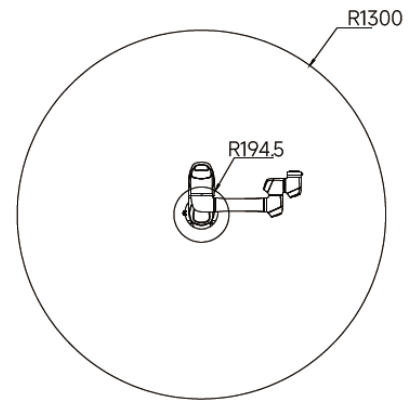
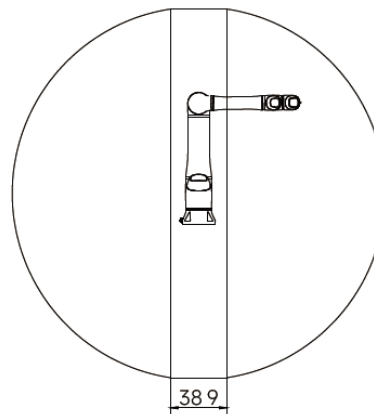
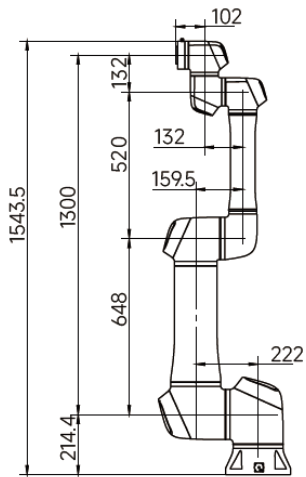

Robotics Business

Autonomous, Secure and Reliable | A Full-System Principle-Driven Robotics Manufacturer

In the industrial robotics sector, STEP harnesses its expertise in motion control to offer a comprehensive range of products under the STEP and ADTECH brands, including collaborative robots, articulated (multi-joint) robots, SCARA robots, and semiconductor robots. As a leading company in China's industrial robot market, STEP's robots cover a payload range of 1–600 kg and incorporate advanced technologies in robot control systems, servo systems, and software platforms. The company delivers industrial robots and integrated system solutions that help manufacturers move toward high-quality, intelligent production.

STEP is a national high-tech innovator and a key contributor to China's robotics industry standards. The company serves as a member of the National Robot Standardization Committee, Vice Chairman of the China Robot Industry Alliance, and Vice President of both the Shanghai Robot Association and the Shanghai Intelligent Manufacturing Industry Association. STEP's Robot Super Factory has been recognized among Shanghai's TOP 20 Smart Factories and designated a National Intelligent Manufacturing Demonstration Unit by the Ministry of Industry and Information Technology.

In June 2025, Haier Group made a strategic investment in Shanghai STEP Electric Corporation, bringing STEP into the Haier COSMOPlat as an official partner.

50,000+

Cumulative Shipments
(Units)

20,000+

Annual Production Capacity
(units)

1-600kg

Payload range

90 %+

Technology Self-Sufficiency

100+

Model

SCR Series Collaborative Robots



Firm Yet Flexible

Powerful, precise, and adaptable—built for seamless human-robot collaboration and true industrial intelligence.



Proven Craftsmanship

Comprehensive application packages for welding, marking, coating, grinding, and more deliver reliable, production-ready performance.



Complete Model Range

Supports payloads from 3 kg to 30 kg, covering a wide range of industrial automation needs.



Smart Connectivity

Comprehensive ecosystem interfaces enable seamless integration with smart devices, software platforms, and automation systems.



Stable and Reliable

Engineered for high stability and strong anti-interference performance, ensuring dependable operation in complex industrial environments.



Product Selection



Model		SCR 3	SCR 5	SCR 7	SCR 12	SCR 16	SCR 20	SCR 30	
Degrees of Freedom		6							
Payload (kg)		3	5	7	12	16	20	30	
Working radius (mm)		620	900	800	1300	1000	1700	1300	
Repeatability (mm)		±0.02	±0.02	±0.02	±0.03	±0.03	±0.05	±0.05	
Weight (including cables) (kg)		14.5	23	22	37	35	68	66	
Protection Level		IP54							
Motion Parameters	Joint Range of Motion (°) of J1-J6	±360							
	Joint Maximum Speed (°/s)	J1	180	180	180	120	120	120	120
		J2	180	180	180	120	120	120	120
		J3	180	180	180	180	180	150	150
		J4	225	180	180	180	180	210	210
		J5	225	180	180	180	180	210	210
		J6	225	180	180	180	180	210	210
Maximum tool speed (m/s)	2	3	2.5	4	3	4.8	4		
Other Features	Typical Power Consumption (W)	150	250	250	350	350	750	750	
	Standard cable length (m)	6							
	Installation orientation	Supports installation at any angle							
	Noise level (dB)	<60dB					<65dB		
	Operating Temperature (°C)	0~50							
	I/O Ports	24 Digital Inputs/24 Digital Outputs 2 Analog Inputs / 2 Analog Outputs							

Basic Dimensions, Working Range Diagram

SCR 3 Unit: mm

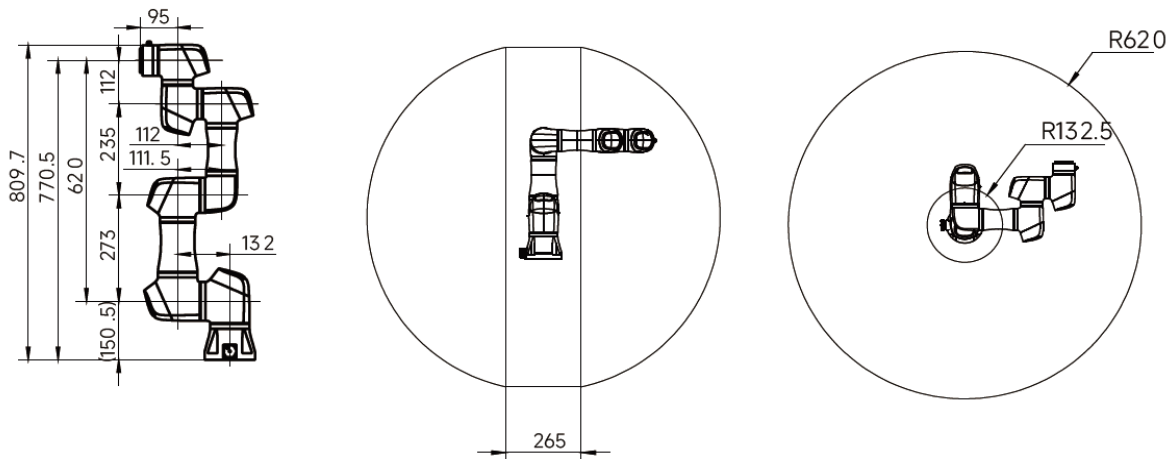

SCR 5 Unit: mm

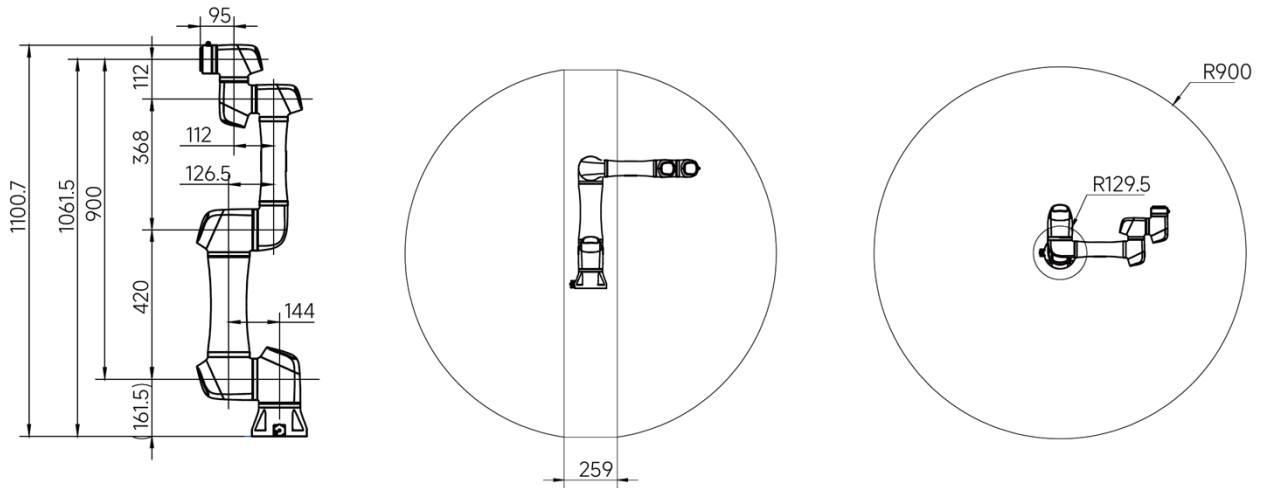

SCR 7 Unit: mm

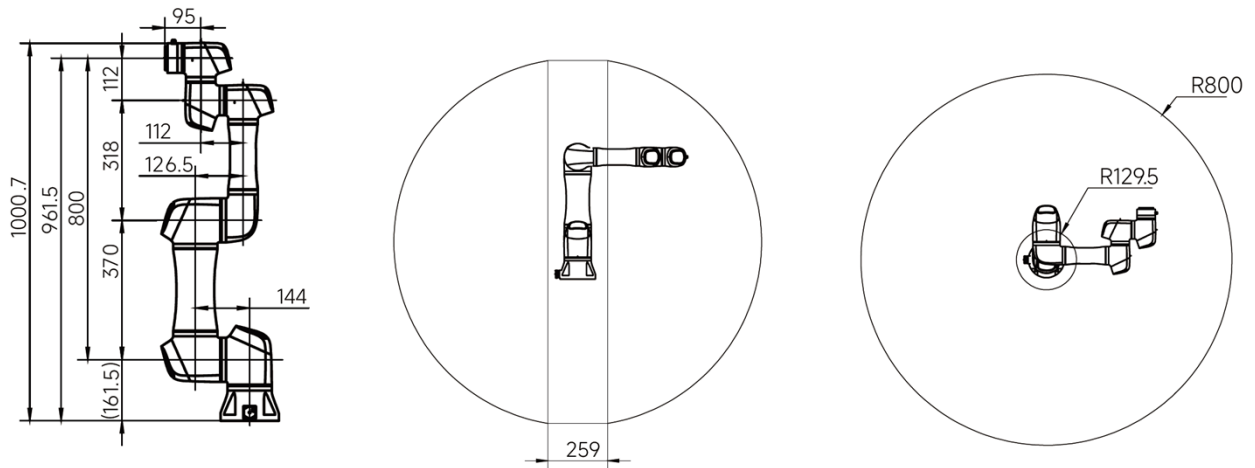

SCR 12 Unit: mm

